

AIR CONDITIONING UNIT FOR THE DRIVER'S ZONE

CITYSPHERE S



SMALL SOLUTION – HIGH EFFICIENCY

We have quickly responded to the call for a maintenance- and user-friendly driver's zone air conditioning unit that is easy to install.

The result is the Citysphere S and is based on our successful Citysphere model. By virtue of its compact dimensions and existing application interfaces, installation is astoundingly simple.

In combination with a classical Citysphere above the passenger compartment, this solution for the driver's zone presents a harmonious appearance in terms of design on the bus roof.

HIGHLIGHTS



Low life-cycle costs

- High lifetime through EC fans
- High durability by semi-hermetic compressor
- Easily accessible for service work



Environmentally friendly

- Noise-optimised operation compared to predecessor model Easysphere



Comfort

- Constant cooling performance



Easy installation:

- Compact system pre-filled with refrigerant
- Installation or retrofitting in a single day

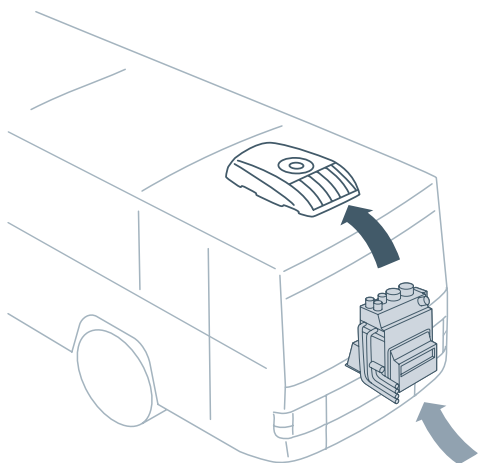

Citysphere S is a split unit based on the Citysphere. The condenser, located in the vehicle's standard heating ventilation unit, is connected to the roof-top unit by two refrigerant hoses. Air is circulated through air ducts at the driver's zone.

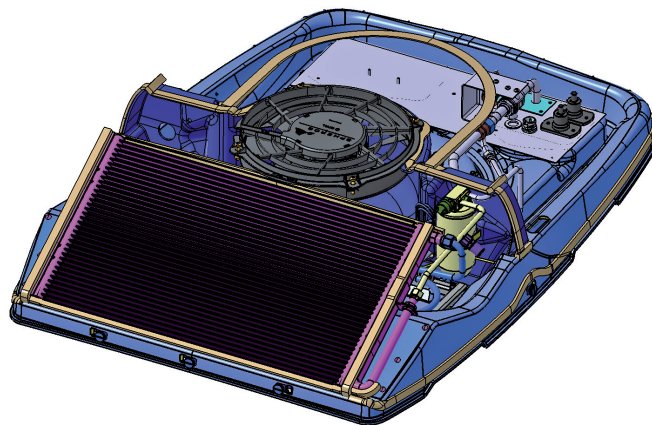

TECHNICAL DATA

Voltage (V)	24
Overall power consumption, max. (A)	65 (24 V)
Dimensions L x B x H (mm)	1,200 x 860 x 250
Cooling capacity (kW)	3.8
Weight (kg)	43
Refrigerant capacity (kg)	R 134 a 1.1
CO ₂ -equivalence (t)	1.6

Contains fluorinated greenhouse gases